

Wall mounted luminaire with asymmetric light distribution that provides ambient light on vertical surfaces. Suitable for exterior applications.

Luminaire characteristics:

Power input: 15W
Lumens: 479lm (for 3000K, 80CRI)
Luminaire efficacy: 31lm/W

Source: LED module (LM-80 tested)
2700K: 80CRI,
3000K: 80CRI,
4000K: 80CRI.

Lumen maintenance: 80% of initial lumens at 70 000 hours (L80)(LM-79)

Optics: Accent light. Its front cover can be positioned to obtain symmetrical or asymmetrical light distribution.

Material: Body: Die-cast aluminum
Diffuser: Clear tempered glass. Methacrylate concentrating lens.
Hardware: Stainless steel screws and silicone gaskets

Electrical: Universal high efficiency remote LED driver rated at 50 000 hours, 120-277V

Dimming: 0-10V (120-277V), down to 10%.

Mounting: See mounting options on page 3.

Finish: White or Aluminum gray.

Weight: 2.2lbs (1kg).

Warranty: 5 year limited warranty.

Ratings: IP54, IK08

Certification: cULus listed for wet location

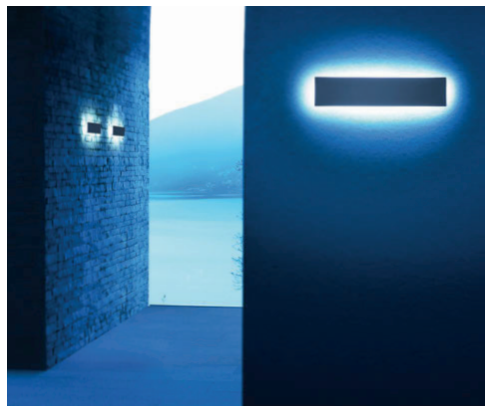

DIMENSIONS

**Appeal
S6400**

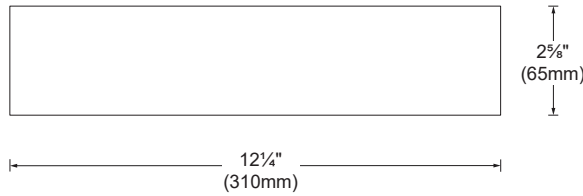

FRONT VIEW

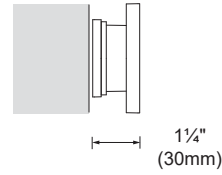

SIDE VIEW

LIGHT DISTRIBUTION

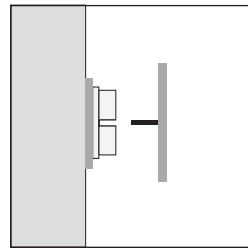
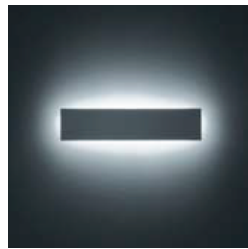
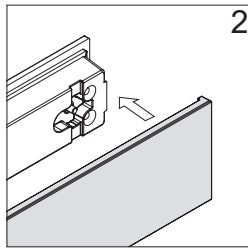
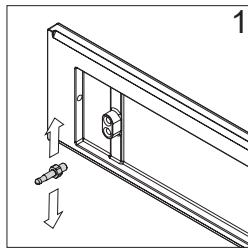

Symmetrical

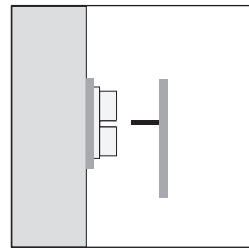
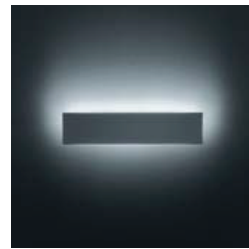

Asymmetrical up

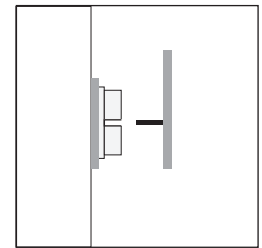
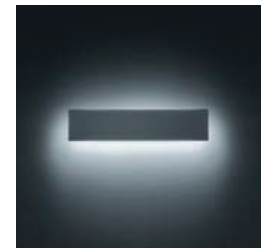

Asymmetrical down

MOUNTING OPTIONS

DF-REM - Direct feed with remote power supply.
Connections made inside fixture (14-18AWG). Rigid or flexible conduit up to Ø1" cable, romex or bx. Installed directly to surface.

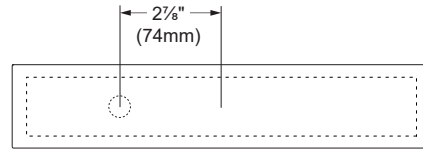
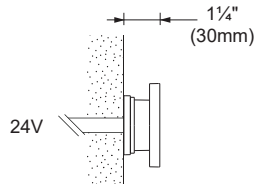

J2-REM - 2" junction box with remote power supply. Mounting adapter plate for junction box installation. Min 1 3/8" (48mm) deep

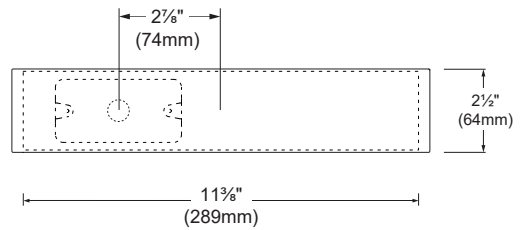
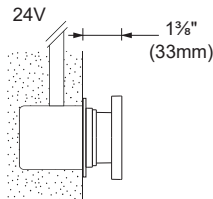

JB-UNV - 4" junction box with integral power supply. Mounting adapter plate for junction box installation. Min 1 1/2" (38mm) deep

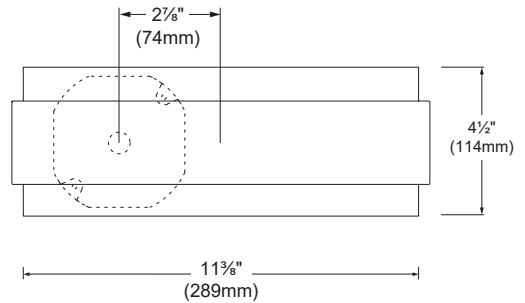
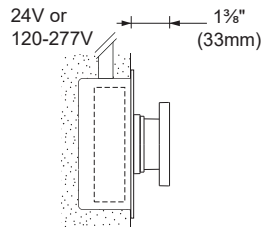

JB-REM - 4" junction box with remote power supply. Mounting adapter plate for junction box installation. Min 1 1/2" (38mm) deep

PHOTOMETRIC DATA

Visit sistemalux.com for complete photometric data.

CCT (K)	CRI	LOAD (W)	OPTIC	LUMENS (lm)	EFFICACY (lm / W)	MAX CANDELA (cd)	MODELS
3000K	80	15W	Accent light	479	31	125	S6400W

Accent light (3000K, 80CRI)

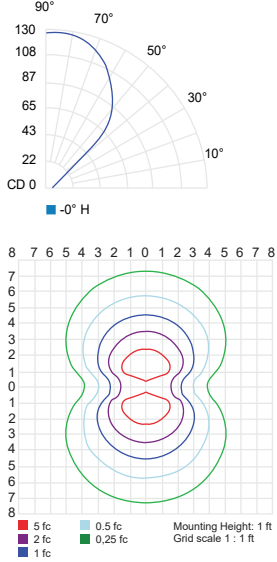

CCT options	2700K	3000K	4000K
CRI options	80CRI	80CRI	80CRI
Multiplier	0.94	1	1.07

ORDERING INFO

FIXTURE

MODEL

S6400 - Appeal led

LED

H - 2700K, 80CRI

W - 3000K, 80CRI

N - 4000K, 80CRI

MOUNTING

DF - Surface mounted with direct feed

JB - Surface mounted junction box

J2 - Surface mounted single gang box

VOLTAGE

UNV - 120-277V

REM - Remote

FINISH

01 - White

14 - Aluminum

DIMMING

D10 - 0-10V

REMOTE POWER SUPPLY OPTION
(TO BE ORDERED SEPARATELY)

Min-max units	Watts	Voltage	Rated	Dimming protocol	Dimming range	Connexion box dimensions	Max distance 18AWG	Connexion box
1	25	120-277V	Indoor	-		6" X 4" X 3" (152 X 102 X 76mm)	30ft (9m)	4444-0024-025-UNV-ND <input type="checkbox"/>
1-5	75	120-277V	Indoor	0-10V	10%	12" X 8" X 4" (304 X 203 X 101mm)	30ft (9m)	4449-0024-075-UNV-D10 <input type="checkbox"/>
1-5	75	120-277V	Outdoor	0-10V	10%	14.5" X 5" X 3.5" (368 X 127 X 88mm)	30ft (9m)	4549-0024-075-UNV-D10 <input type="checkbox"/>
1-5	75	120-277V	Outdoor	-		11.5" X 3" X 2" (292 X 76 X 50mm)	30ft (9m)	4545-0024-075-UNV-ND <input type="checkbox"/>
1-5 (3-5 for DIM)	80	120V	Outdoor	Leading and trailing edge (ELV and TRIAC)	Down to ±15%	14.5" X 5" X 2" (368 X 125 X 50mm)	30ft (9m)	4551-0024-080-120-LTE <input type="checkbox"/>
2-7 (MAX 14/ch)	200	120-277V	Outdoor	-		12" X 4.5" X 2.5" (304 X 114 X 63mm)	30ft (9m) Per channel	4546-0024-200-2C-UNV-ND <input type="checkbox"/>